

a streamside garden

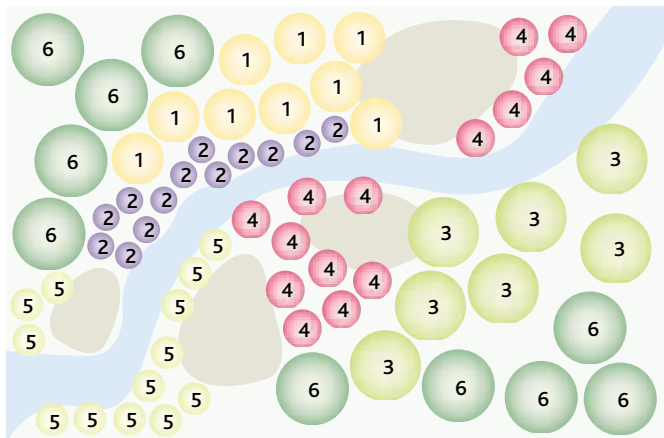

What could be more appealing than a garden with a stream running through it? It's a gardener's dream. But it's critical to plan carefully to fully realize the potential of such a charming site. This garden is designed for an area approximately 11 feet long and seven feet wide, but the plantings can be repeated effectively for a larger space. The plants selected here provide interest in spring, in a full- or part-sun location where the soil is boggy or wet for most of the year; they are suitable for Zones 4 to 8. For the first few seasons keep the site well weeded; as the plants fill in weeds will seldom be a problem. 🐸



key to plan

- 1. Marsh marigold** (*Caltha palustris*) 9 plants spaced 1' apart; 1' to 2' tall, 18" across; clumps of glossy, heart-shaped leaves and 1" buttercup flowers in early spring; summer-dormant perennial.
- 2. Water forget-me-not** (*Myosotis scorpioides*) 13 plants spaced 8" apart; 6" to 12" tall; 6" across; masses of tiny, yellow-eyed blue flowers among sprawling mounds of narrow leaves; perennial.
- 3. Yellow flag iris** (*Iris pseudacorus*) 7 plants spaced 18" apart; 3' to 6' tall; wide clumps of sword-shaped foliage and yellow flowers; spreads to make large colonies; perennial.
- 4. Japanese primrose** (*Primula japonica*) 14 plants in 1 group of 9 and 1 group of 5, spaced 9" apart; 12" to 30" tall; 12" across; robust stems bear tiers of pink, crimson, or white flowers above wrinkled, paddle-shaped leaves; self-seeds; perennial.
- 5. Golden creeping Jenny** (*Lysimachia nummularia* 'Aurea') 13 plants in 2 groups of 3 and 1 group of 7, spaced 9" apart; 3" tall; creeping mats of rounded 1" yellow leaves; 3/4" yellow flowers; perennial.
- 6. Ostrich fern** (*Matteuccia struthiopteris*) 10 plants in 2 groups of 5, spaced 18" apart; 4' to 6' tall; 2' to 3' across; vase-shaped clumps of plumelike leaves, brown woody fruiting fronds; vigorous perennial. In Zones 6 to 8 substitute Oriental ostrich fern (*M. orientalis*).

ILLUSTRATION: MICHELLE BURCHARD